

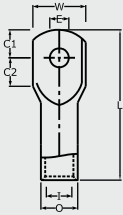

**High Voltage  
Copper Terminals 33Kv**

- Electrolytic high conductivity copper
- Electro tinned plated
- Copper finish on request



Product Ref	Conductor Size mm2	Stud Hole		I	O	C1	C2	L
		E	W					
CHVT 25-10	25	10.5	18	6.8	11	10	11	51
CHVT 25-12	25	13	21			10	11	51
CHVT 35-10	35	10.5	19	8.2	12.5	10	11	53
CHVT 35-12	35	13	19			10	11	53
CHVT 50-10	50	10.5	20	9	14	12	14	55
CHVT 50-12	50	13	20			12	14	55
CHVT 70-10	70	10.5	23	11.2	16	12	14	70
CHVT 70-12	70	13	23			12	14	70
CHVT 95-10	95	10.5	25	13.5	18	12	14	78
CHVT 95-12	95	13	25			12	14	78
CHVT 95-16	95	17	29			12	14	78
CHVT 120-12	120	13	31	15	21.5	12	14	82
CHVT 120-14	120	15	31			12	14	82
CHVT 120-16	120	17	31			12	14	82
CHVT 150-12	150	13	34	16.5	23	14	16	98
CHVT 150-14	150	15	34			14	16	98
CHVT 150-16	150	17	34			14	16	98
CHVT 185-12	185	13	37	17.5	24.5	16	16	101
CHVT 185-14	185	15	37			16	16	101
CHVT 185-16	185	17	37			16	16	101
CHVT 240-12	240	13	43	19.5	27	16	18	101
CHVT 240-16	240	17	43			16	18	101
CHVT 240-20	240	21	43			16	18	101
CHVT 300-12	300	13	46	23.5	32	16	20	112
CHVT 300-16	300	17	46			16	20	112
CHVT 300-20	300	21	46			16	20	112
CHVT 400-12	400	13	51	27	37	24	27	140
CHVT 400-16	400	17	51			24	27	140
CHVT 400-20	400	21	51			24	27	140
CHVT 500-12	500	13	56	30.5	42	24	27	147
CHVT 500-16	500	17	56			24	27	147
CHVT 500-20	500	21	56			24	27	147
CHVT 630-12	630	13	64	35	47	24	27	159
CHVT 630-16	630	17	64			24	27	159
CHVT 630-20	630	21	64			24	27	159

**High Voltage Copper  
Through Connectors 33Kv**

- Electrolytic high conductivity copper
- Electro tinned plated
- Copper finish on request

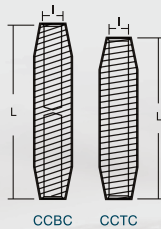

Product Ref.	Dimensions mm	
	I	L
CCBC / CCTC 25	6.8	60
CCBC / CCTC 35	8.2	60
CCBC / CCTC 50	8.7	60
CCBC / CCTC 50L	9.5	60
CCBC / CCTC 70	11	70
CCBC / CCTC 95	12	80
CCBC / CCTC 95L	13.5	80
CCBC / CCTC 150	15	80
CCBC / CCTC 150L	16.5	80
CCBC / CCTC 185	17	100
CCBC / CCTC 240	19.2	100
CCBC / CCTC 300	21.5	100
CCBC / CCTC 300L	23.7	100
CCBC / CCTC 400	27	120
CCBC / CCTC 500	30.3	118
CCBC / CCTC 630	33.4	130